

Therm-Equip, Inc.



PC300



PC700

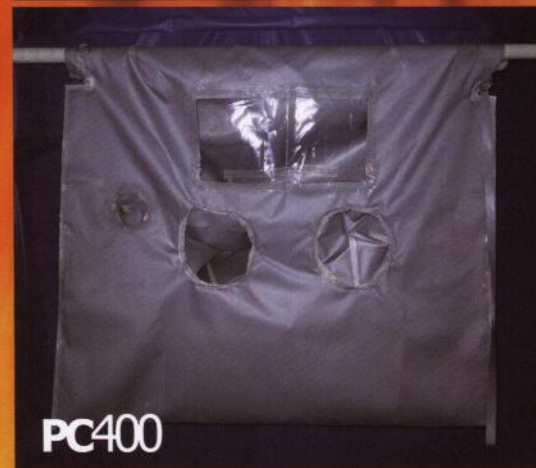

PC400

High Temperature Application
GLOVEBAGS



Therm-Equip, Inc.

High Temperature Application

GLOVEBAGS

Therm-Equip Glovebags are designed for the removal of asbestos containing insulation from high-temperature pipes and ducts.

Therm-Equip Glovebags offer the ability to handle emergency repair and maintenance on active pipe and ducts. The bags eliminate the need for costly shut-downs in power plants, paper mills, refineries and other industry. Therm-Equip Glovebags are also safe and more cost effective than full scale containment methods.

Therm-Equip Glovebags are available in three models to accommodate maximum pipe temperatures of 300°, 400° and 700° F. Each model is available in several different sizes to accommodate pipe diameters from 1" to 24", and for horizontal and vertical pipe.

Manufactured by Therm-Equip and available exclusively through Grayling Industries' authorized distributor network.



AVAILABLE BASIC CONFIGURATIONS

6060
Stock- 300, 400, 700

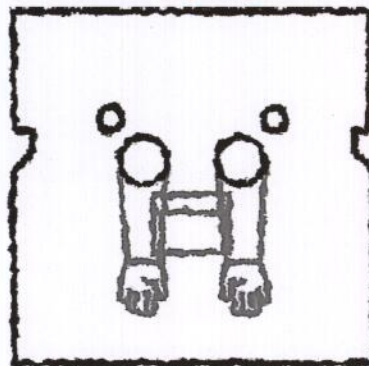

6072
Stock- 300, 400, 700

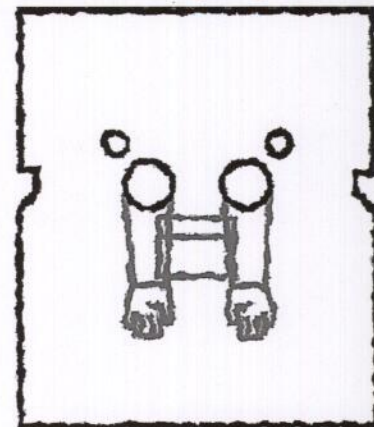

Special order glovebags are not returnable and require a 2-week minimum for production

Other sizes are available for unique applications; 7296-2 and 72120-2

Therm-Equip, Inc. 3805 Maplewood, S.W., Canton, OH 44706 (330) 484-5384



PC300

The PC300 will allow the removal of asbestos from pipes and ducts up to 300° F. The clear high-temperature plastic body is double stitched with leather gloves that are sealed air-tight to the sleeves. Designed for low pressure steam lines and hot water heating systems.

Useful Temp- up to 300° F.
 Standard Sizes- 6060, 6072
 Special Order Sizes- 6084-2, 7296-2, 72120-2, V10 and V24-2
 Maximum Load- 50 lbs.



PC400

The PC400 is designed for removal of insulation at intermediate temperatures up to 400° F. The construction is impregnated woven opaque high temperature fabric with full stitched and sealed seams. Insulated leather work gloves are sealed to high temperature resistant sleeves. Workers view the work area through a translucent window above the glovesleeve assembly.

Useful Temp- up to 400° F.
 Standard Sizes- 6060, 6072
 Special Order Sizes- 6084-2, 7296-2, 72120-2, V10 and V24-2
 Maximum Load- 1000 lbs.



PC700

The PC700 is designed for removal of insulation at high temperatures up to 700° F. The construction is impregnated woven opaque high temperature fabric with full stitched and sealed seams. Insulated leather work gloves are sealed to high temperature resistant sleeves. Workers view the work area through a translucent window above the glovesleeve assembly.

Useful Temp- up to 700° F.
 Standard Sizes- 6060, 6072
 Special Order Sizes- 6084-2, 7296-2, 72120-2, V10 and V24-2
 Maximum Load- 1000 lbs.



Each Pipe Case is equipped with protective gloves designed for the temperature application

6084-2

Special order- 300,400, 700

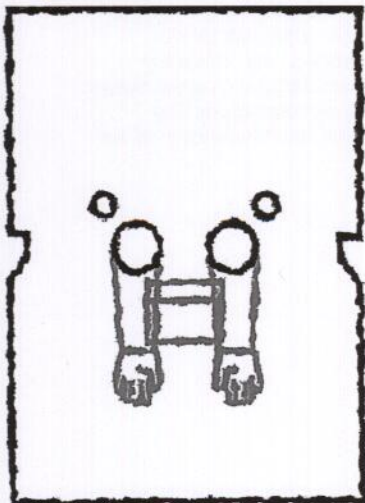

V10

Special order- 300,400, 700

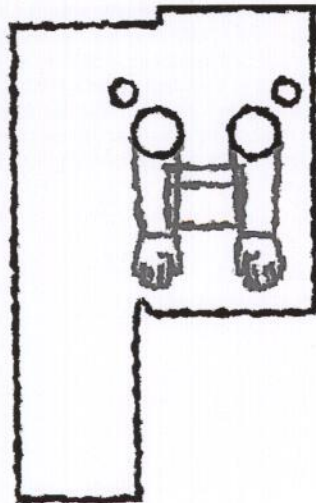

V24

Special order- 300,400, 700

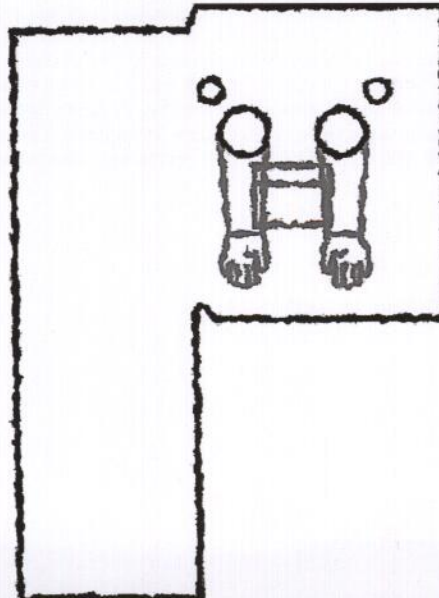

Therm-Equip
High Temperature Application Glovebag Specifications

| model | PC300 | PC400 | PC700 |
|-------------------------|--|---|---|
| maximum pipe temp | up to 300°F | -40°F to 400°F | -40°F to 700°F |
| material | stitched and sealed hi-temp plastic film | stitched and sealed hi-temp woven fabric | stitched and sealed hi-temp woven fabric |
| maximum load | 50 lbs. | 1000 lbs. | 1000 lbs. |
| viewing area | clear bag | 10" x 22" window | 10" x 22" window |
| pipe config. | horizontal | horizontal | horizontal |
| strl. sizes available | 6060, 6072 | 6060, 6072 6084 | 6060, 6072 |
| special sizes available | 6084-2, 7296-2 72120-2, V10 V24-2 | 6084-2, 7296-2, 72120-2 V10, V24-2 | 6084-2, 7296-2, 72120-2, V10 V24-2 |

CAUTIONS

Therm-Equip high temperature application glovebags are designed as one-time use devices in accordance with federal asbestos regulations. Working on pipe that is elevated in temperature exposes workers to numerous hazards that should be carefully considered before commencing work. A qualified mechanical engineer and safety personnel should be consulted prior to working with this product. Pipe may be under high pressure and can be subject to mechanical failure due to work performed. Leaking steam or gasses may be invisible to the naked eye and can cause serious injury or even death. Rapid thermal expansion and contraction can cause additional stress on pipe, workers should consider all applicable safety precautions for the particular work activities. Wetting agents will emit large amounts of steam if they are sprayed on hot pipes and insulation, therefore it is recommended that hot removal be performed without wetting. Asbestos containing material can be wetted after they have had sufficient time to cool. The user should determine the suitability of this product for the particular use. Additional information as to use, applicable laws or governmental regulations may be necessary for the user to determine this product's suitability for the particular use. Since the manner in which this product is used is beyond the manufacturer's or representing agent's control, the manufacturer or agent makes no warranty of any kind, express or implied, including the warranties of fitness for a particular purpose or merchantability. The manufacturer or agent does not assume any liability arising out of the use by others of this product. It is the recommendation of the manufacturer and agent that the user check and conform to all applicable regulations prior to any work.

Available exclusively through
Grayling Industries'
authorized distributor network



Grayling Industries, Inc.
1008 Branch Drive
Alpharetta, GA 30004 USA
www.graylingindustries.com

FOR MORE INFORMATION
(800)635-1551